

TECHNICAL MANUAL

ORGANIZATIONAL, DIRECT SUPPORT, AND  
GENERAL SUPPORT MAINTENANCE  
REPAIR PARTS AND SPECIAL TOOLS LISTS  
(INCLUDING DEPOT MAINTENANCE  
REPAIR PARTS AND SPECIAL TOOLS)

FOR

POWER SUPPLY PP-2309C/U

(NSN 6130-00-752-2215)

Technical Manual }  
 No. 11-6130-245-24P-2 }

HEADQUARTERS  
 DEPARTMENT OF THE ARMY  
 WASHINGTON, DC, 8 June 1982

**ORGANIZATIONAL, DIRECT SUPPORT, AND GENERAL  
 SUPPORT MAINTENANCE  
 REPAIR PARTS AND SPECIAL TOOLS LISTS  
 (INCLUDING DEPOT MAINTENANCE REPAIR PARTS  
 AND SPECIAL TOOLS)  
 FOR  
 POWER SUPPLY PP-2309C/U  
 (NSN 6130-00-752-2215)**

Current as of 12 February 1982

**REPORTING ERRORS AND RECOMMENDING IMPROVEMENTS**  
 You can help improve this manual. If you find any mistakes or if you know of a way to improve the procedures, please let us know. Mail your letter, DA Form 2028 (Recommended Changes to Publications and Blank Forms), or DA Form 2028-2 located in the back of this manual direct to Commander, US Army Communications-Electronics Command and Fort Monmouth; ATTN: DRESL-ME-MQ, Fort Monmouth NJ 07703.  
 In either case, a reply will be furnished direct to you.

**Table of Contents**

		Page	Illus Figure
Section	I. Introduction . . . . .	1	
	II. Repair Parts . . . . .	5	
Group	00 Power Supply PP-2309C/U . . . . .	5	1
	01 Main Assembly 0376 -746 . . . . .	11	2
	0101 Front Panel Assembly 0376-708. . . . .	15	3
	010101 Printed Circuit Board Assembly 0376-707 . . . . .	17	4
	0102 Heat Sink Assembly 0376-741 . . . . .	19	5
	101201 Resistor Board Assembly 0376-717. . . . .	21	6
Section	III. Special Tools List (Not applicable)		
	IV. National Stock Number and Part Number Index . . . . .	22	

## SECTION I

### INTRODUCTION

#### 1. Scope

This manual lists spares and repair parts; special tools; special test, measurement, and diagnostic equipment (TMDE), and other special support equipment required for performance of organization direct support, and general support maintenance of the PP-2309C/U. It authorizes the requisitioning and issue of spares and repair parts as indicated by the source and maintenance codes.

#### 2. General

This Repair Parts and Special Tools List is divided into the following sections

**a. Section II. Repair Parts List.** A list of spares and repair parts authorized for use in the performance of maintenance. The list also includes parts which must be removed for replacement of the authorized parts. Parts lists are composed of functional groups in numeric sequence, with the parts in each group listed in figure and item number sequence.

**b. Section III. Special Tools List.** Not applicable.

**c. Section IV. National Stock Number and Part Number Index.** A list, in National item identification number (NIIN) sequence, of all National stock numbers (NSN) appearing in the listings, followed by a list, in alphameric sequence, of all part numbers appearing in the listings. National stock numbers and part numbers are cross-referenced to each illustration figure and item number appearance.

#### 3. Explanation of Column

**a. Illustration** This column is divided as follows:

**(1) Figure number.** Indicates the figure number of the illustration on which the item is shown.

**(2) Item number.** The number used to identify item called out in the illustration.

**b. Source, Maintenance, and Recoverability (SMR) codes.**

**(1) Source code.** Source codes indicate the manner of acquiring support items for maintenance, repair, or overhaul of end items. Source codes are entered in the first and second positions of the Uniform SMR Code format as follows:

<i>Code</i>	<i>Definition</i>
<b>PA-</b>	Item procured and stocked for anticipated or known usage.
<b>PD-</b>	Support item, excluding support equipment, procured for initial issue or outfitting and stocked only for subsequent or additional initial issues or outfittings. Not subject to automatic replenishment.
<b>PF-</b>	Support equipment which will not be stocked but which will be centrally procured on demand.
<b>MF-</b>	Item to be manufactured or fabricated at the direct support maintenance level.
<b>MH-</b>	Item to be manufactured or fabricated at the general support maintenance level.
<b>MD-</b>	Item to be manufactured or fabricated at the depot maintenance level.
<b>XA-</b>	Item is not procured or stocked because the requirements for the item will result in the replacement of the next higher assembly.
<b>XD-</b>	A support item that is not stocked. When required, item will be procured through normal supply channels.

#### NOTE

**Cannibalization or salvage may be used as a source of supply for any items source coded above except those coded XA and aircraft support items as restricted by AR 700-42.**

**(2) Maintenance code.** Maintenance codes are assigned to indicate the levels of maintenance authorized to USE and REPAIR support items. The maintenance codes are entered in the third and fourth positions of the Uniform SMR Code format as follows:

**(a)** The maintenance code entered in the third position will indicate the lowest maintenance level authorized to remove, replace, and use the support item. The maintenance code entered in the third position will indicate one of the following levels of maintenance

<i>Code</i>	<i>Application/Explanation</i>
<b>O-</b>	Support item is removed, replaced, used at the organizational level.
<b>F-</b>	Support item is removed, replaced, used at the direct support level.

(b) The maintenance code entered in the four. the position indicates whether the item is to be repaired and identifies the lowest maintenance level with the capability to perform complete repair (i.e. all authorized maintenance functions). This position will contain one of the following maintenance codes:

- | <i>Code</i> | <i>Application/Explanation</i>   |
|-------------|--|
| <b>F-</b>   | The lowest maintenance level capable of complete repair of the support item is the direct support level. |
| <b>D-</b>   | The lowest maintenance level capable of complete repair of the support item is the depot level.          |
| <b>Z-</b>   | Nonreparable. No repair is authorized.   |

(3) **Recoverability code.** Recoverability codes are assigned to support items to indicate the disposition action on unserviceable items. The recoverability code is entered in the fifth position of the Uniform SMR Code format as follows:

- | <i>Recoverability codes</i> | <i>Definition</i>   |
|-----------------------------|---|
| <b>Z-</b>                   | Nonreparable item. When unserviceable, condemn and dispose at the level indicated in position 3.  |
| <b>F-</b>                   | Reparable item. When uneconomically repairable, condemn and dispose at the direct support level.  |
| <b>D-</b>                   | Reparable item. When beyond lower level repair capability, return to depot. Condemnation and disposal not authorized below depot level. |

**c. National Stock Number.** Indicates the National stock number assigned to the item and will be used for requisitioning purposes.

**d. Federal Supply Code for Manufacturer (FSCM).** The FSCM is a 5-digit numeric code listed in SB 708-41/42 which is used to identify the manufacturer, distributor, or Government agency, etc.

**e. Part Number.** Indicates the primary number used by the manufacturer (individual, company, firm, corporation, or Government activity), which controls the design and characteristics of the item by means of its engineering drawings, specifications, standards, and inspection requirements to identify an item or range of items.

**NOTE**

When a stock numbered item is requisitioned, the repair part received may have a different part number than the part being replaced.

**f. Description.** Indicates the Federal item name and, if required, a minimum description to identify the item.

**g. Unit of Measure (U/M).** Indicates the standard of the basic quantity of the listed item as used in

performing the actual maintenance function, This measure is expressed by a two-character alphabetical abbreviation (e.g., ea, in, pr, etc), When the unit of measure differs from the unit of issue, the lowest unit of issue that will satisfy the required units of measure will be requisitioned:

**h. Quantity Incorporated in Unit.** Indicates the quantity of the item used in the breakout shown on the illustration figure, which is prepared for a functional group, subfunctional group, or an assembly.

**4. Special Information**

**a.** Detailed manufacturing instructions for items source coded to be manufactured or fabricated are found in TM 11-6130-245-14-2, Bulk materials required to manufacture items are listed in the Bulk Material Group of this manual.

**b.** The following publications pertain to the PP-2309C/U and its components: TM 11-6130-245-14-2, Power Supply PP-2309C/U.

**c.** National stock numbers (NSN's) that are missing from P source coded items have been applied for and will be added to this TM by future change/revision when they are entered in the Army Master Data File (AMDF). Until the NSN's are established and published, submit exception requisitions to Commander, US Army Communications-Electronics Material Readiness Command, and Fort Monmouth ATTN: DRSEL-MM, Fort Monmouth, NJ 07703 for the part required to support your equipment.

**5. How to Locate Repair Parts**

**a.** When National stock number or part number is unknown.

(1) **First.** Using the table of contents, determine the functional group within which the item belongs. This is necessary since illustrations are prepared for functional groups and listings are divided into the same groups.

(2) **Second.** Find the illustration covering the functional group to which the item belongs.

(3) **Third.** Identify the item on the illustration and note the illustration figure and item number of the item.

(4) **Fourth.** Using the Repair Parts Listing, find the figure and item number noted on the illustration.

**b.** When National stock number or part number is known.

(1) **First.** Using the Index of National Stock Numbers and Part Numbers, find the pertinent National stock number or part number. This index is in NIIN sequence followed by a list of part num-

bars in alphameric sequence, cross-referenced to the illustration figure number and item number.

**(2) Second.** After finding the figure and item number, locate the figure and item number in the

repair parts list.

**6. Abbreviations**

Not applicable.

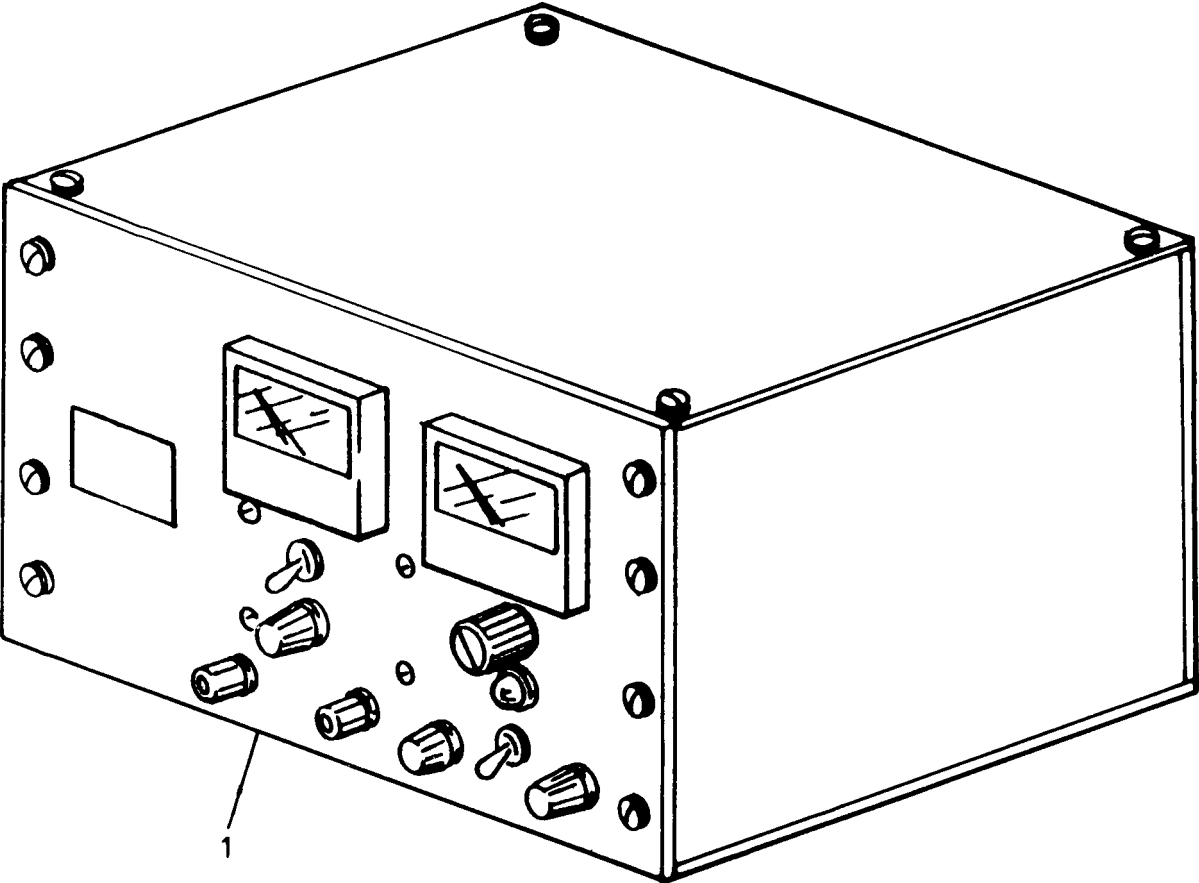

EL6GJ009

Figure 1. Power Supply PP-2309C/U

(1) ILLUSTRATION (A) FIG NO	(2) (B) ITEM NO	(3) SMR CODE	(3) NATIONAL STOCK NUMBER	(4) FSCM	(5) PART NUMBER	(6) DESCRIPTION	(7) USABLE ON CODE	(8) QTY INC IN UNIT
1	1	PAODD	6130-00-752-2215	12867	MODEL TR100	GROUP 00 POWER SUPPLY PP-2309C/U POWER SUPPLY PP-2309C/U		EA 1

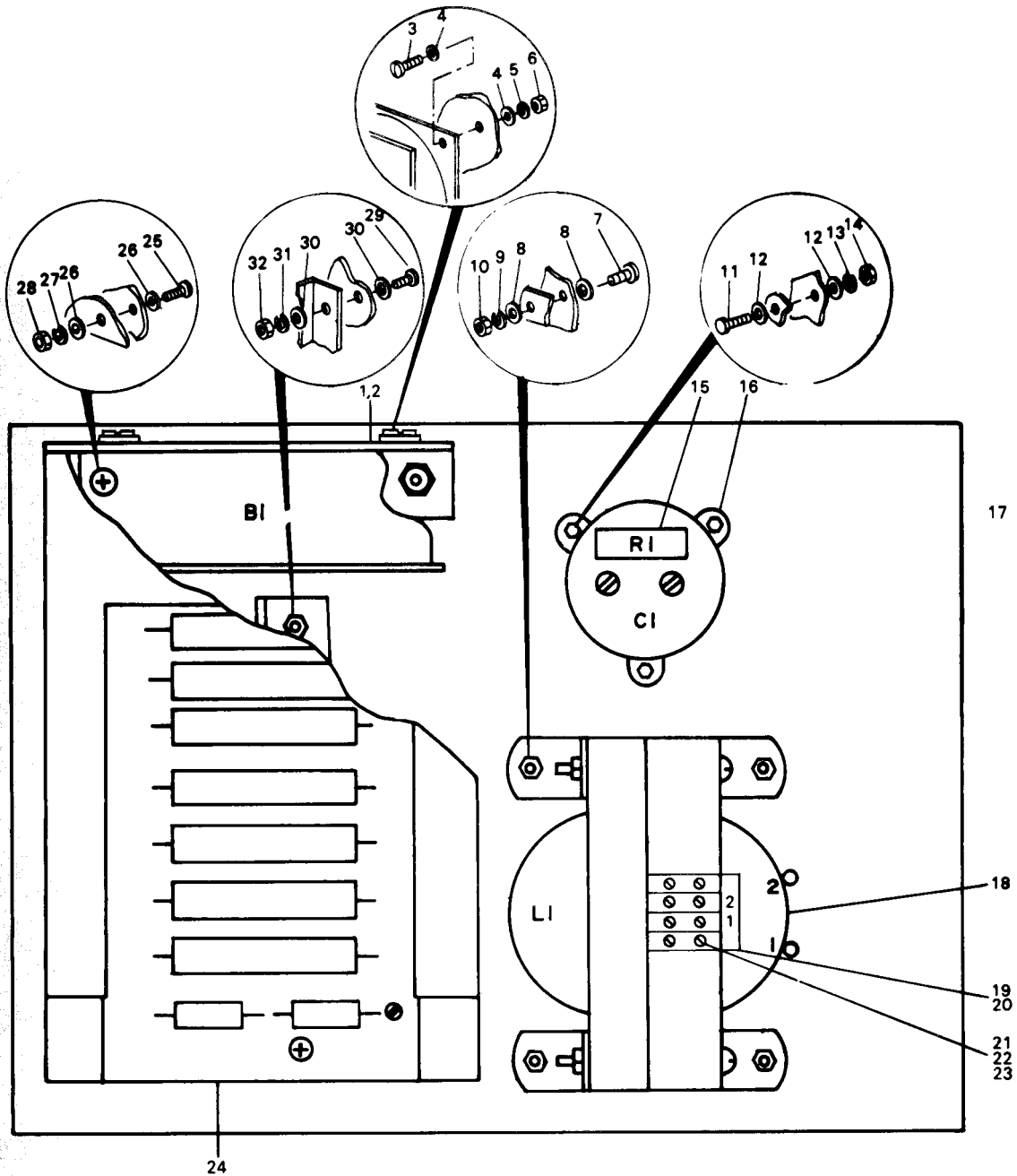

EL6GJ004

Figure 2. Main Assembly 0376-746 (Sheet 1 of 4)



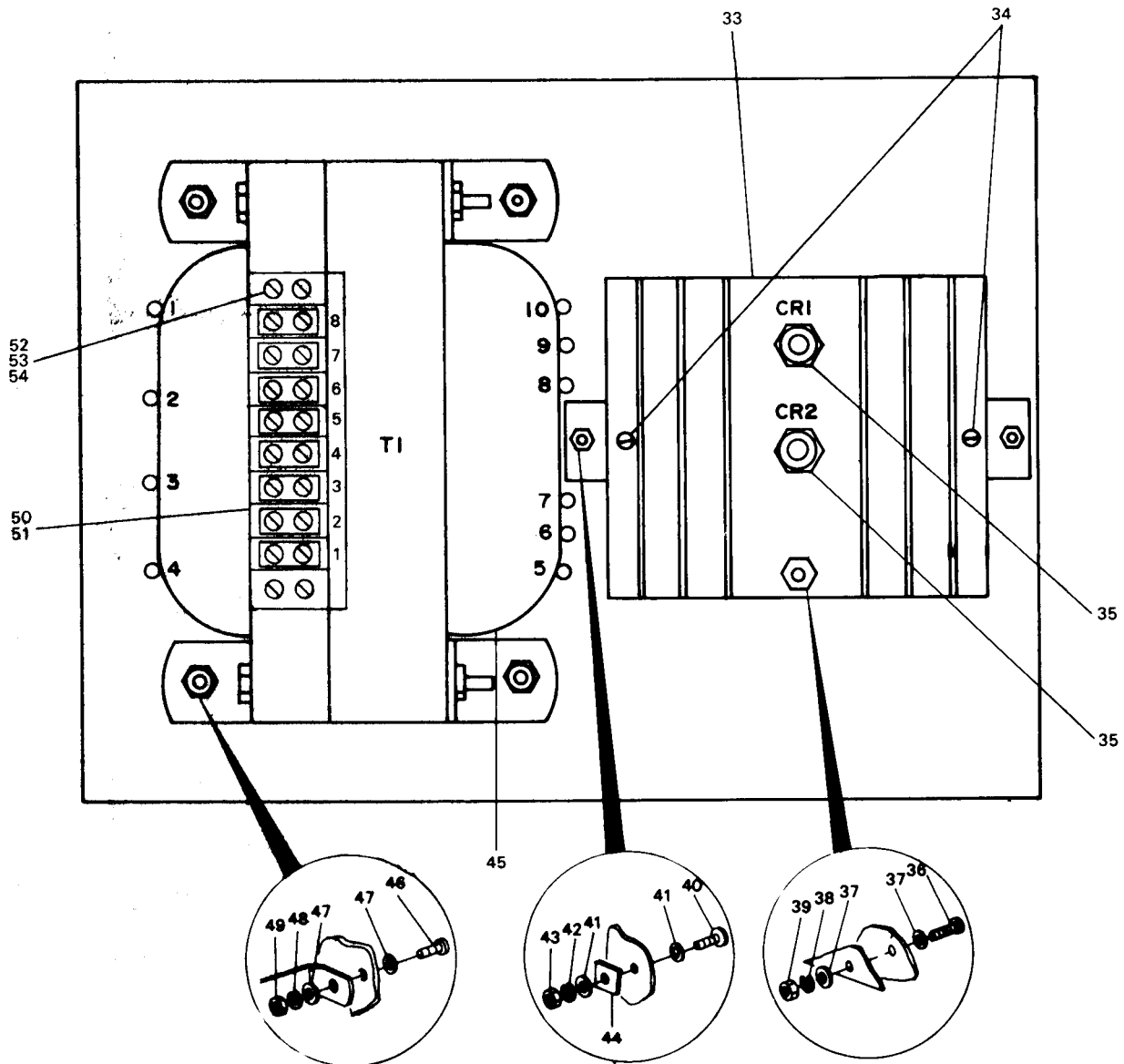

EL6GJ002

Figure 2. Main Assembly 0376-746 (Left Side Panel) (Sheet 2 of 4)

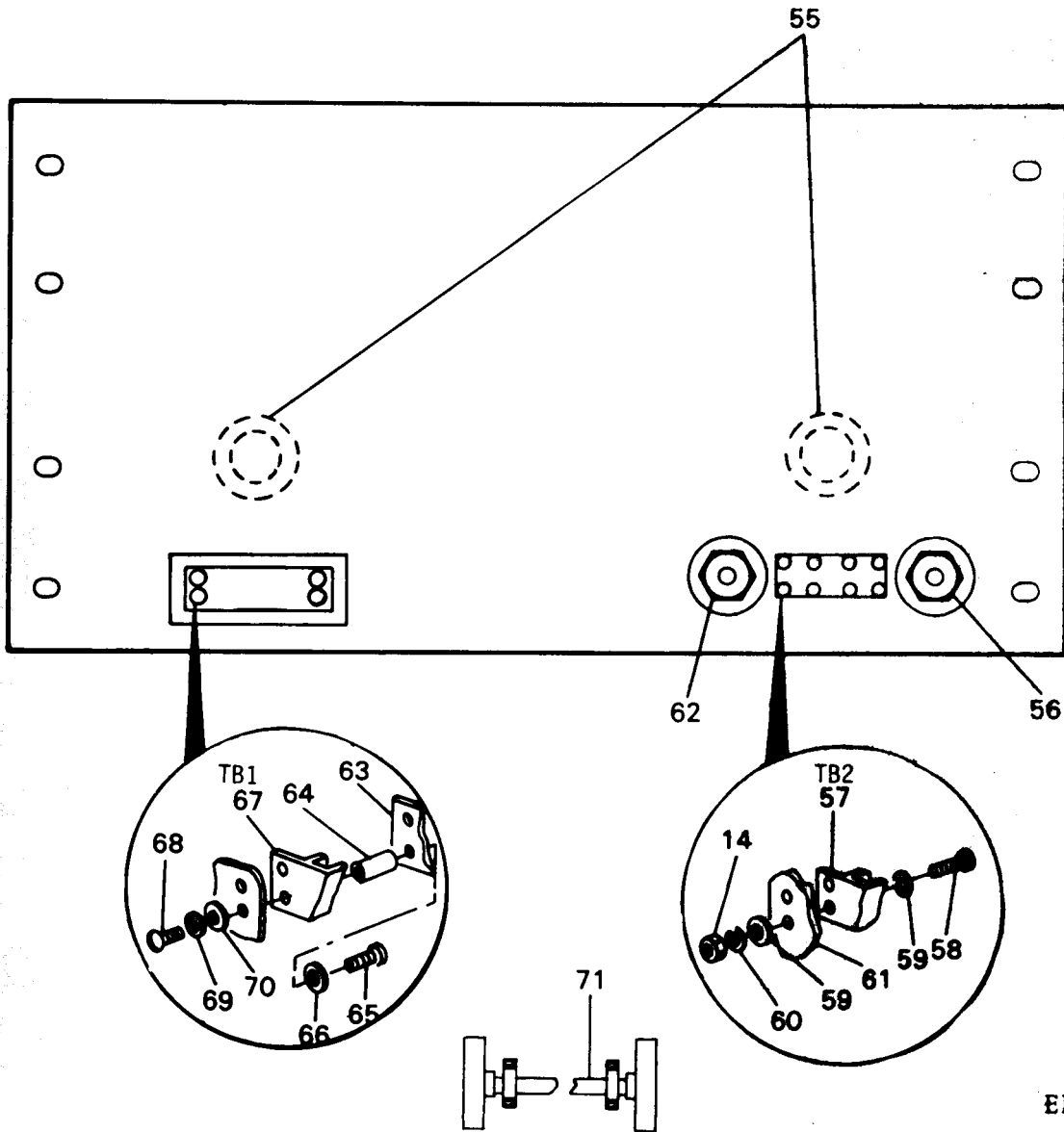

EL6GJ003

Figure 2. Main Assembly 0376-746 (Back Panel) (Sheet 3 of 4)

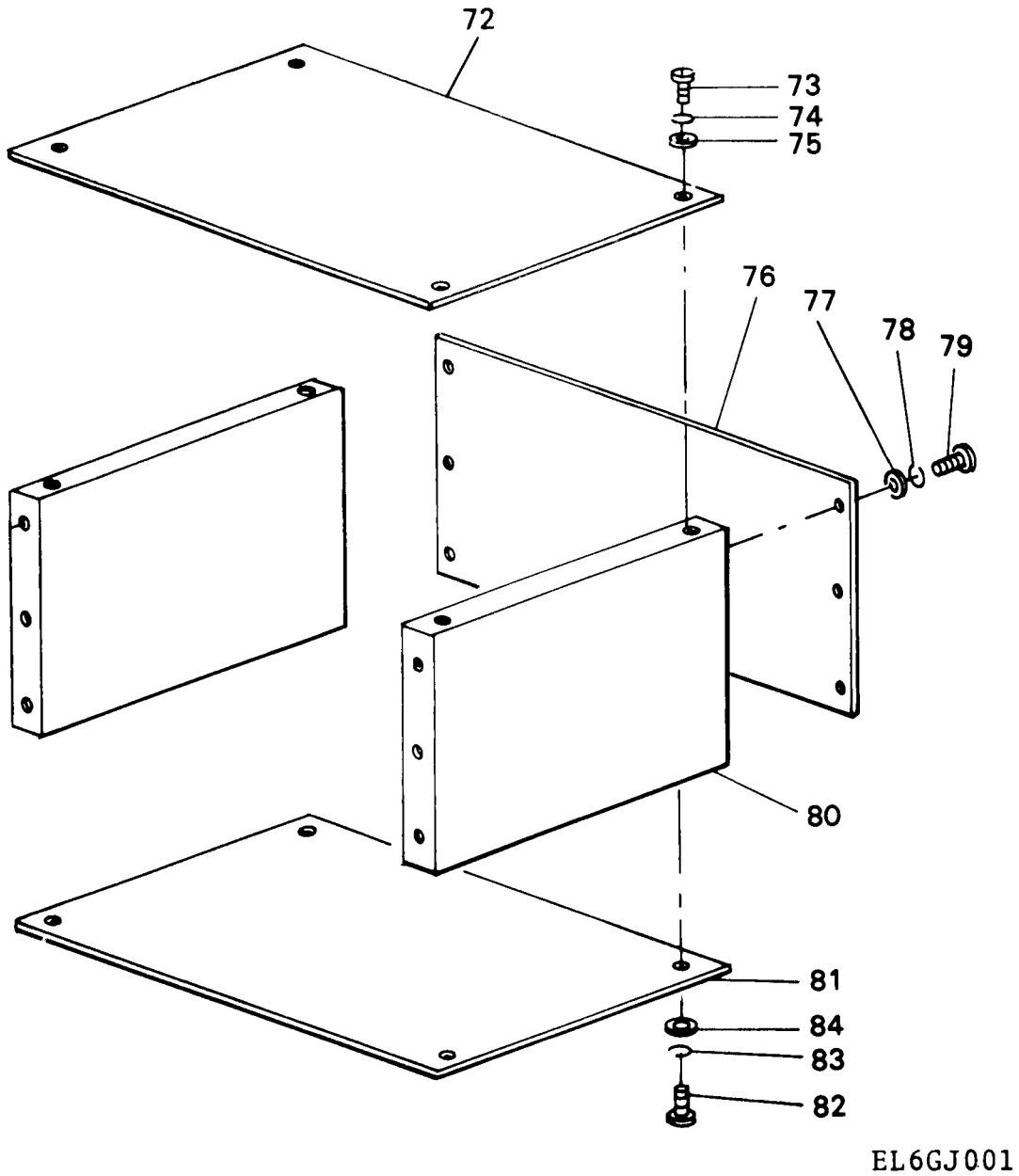

EL6GJ001

Figure 2. Main Assembly 0376-746 (Cabinet Assembly) (Sheet 4 of 4)

SECTION II (1) ILLUSTRATION		(2)	(3)	TM11-6130-245-24P-2		(6)	(7)	(8)
(A) FIG NO	(B) ITEM NO	SMR CODE	NATIONAL STOCK NUMBER	(4) FSCM	(5) PART NUMBER	DESCRIPTION	USABLE ON CODE U/M	QTY INC IN UNIT
GROUP 01 MAIN ASSEMBLY								
2	1	PAFZZ	7021-00-483-0051	92702	WS2107FL	BOXER FAN, COMPUTER	EA	1
2	2	MDFZZ		12867	0376-1029	BRKT, SUPPORT, BLWR	EA	1
2	3	PAFZZ	5305-00-579-2136	96906	MS35265-32	SCREW, MACHINE	EA	4
2	4	PAFZZ	5310-00-722-5998	96906	MS15795-805	WASHER, FLAT	EA	8
2	5	PAFZZ	5310-00-929-6395	96906	MS35338-136	WASHER, LOCK	EA	4
2	6	PAFZZ	5310-00-934-9761	96906	MS35649-264	NUT, PLAIN, HEXAGON	EA	4
2	7	PAFZZ	5305-00-837-8918	96906	MS35274-64	SCREW, MACHINE	EA	4
2	8	PAFZZ	5310-00-619-1148	96906	MS15795-808	WASHER, FLAT	EA	8
2	9	PAFZZ	5305-00-054-6656	96906	MS35338-138	SCREW, MACHINE	EA	4
2	10	PAFZZ	5310-00-934-9751	96906	MS35650-302	NUT, PLAIN, HEXAGON	EA	4
2	11	PAFZZ	5305-00-579-2139	96906	MS35265-30	SCREW, MACHINE	EA	3
2	12	PAFZZ	5310-00-722-5998	96906	MS15795-805	WASHER, FLAT	EA	6
2	13	PAFZZ	5310-00-929-6395	96906	MS35338-136	WASHER, LOCK	EA	3
2	14	PAFZZ	5310-00-934-9761	96906	MS35649-264	NUT, PLAIN, HEXAGON	EA	3
2	15	PAFZZ	5905-00-975-1153	81349	RW68V511	RESISTOR, FIXED, WIRE	EA	1
2	16	PAFZZ	5910-00-151-7564	37942	VR8	RETAINER, CAPACITOR	EA	1
2	17	PAFZZ		37942	CGS143U050D11	CAPACITOR	EA	1
2	18	XDFZZ		12867	T0326	CHOKE, FILTER	EA	1
2	19	XDFZZ	5940-00-983-6115	81349	38TB2	TERMINAL BOARD	EA	1
2	20	MFFZZ		75382	MS601-2	MARKER STRIP	EA	1
2	21	PAFZZ	5310-00-722-5998	96906	MS15795-805	WASHER, FLAT	EA	4
2	22	PAFZZ	5310-00-929-6395	96906	MS35338-136	WASHER, LOCK	EA	4
2	23	PAFZZ	5305-00-582-5808	96906	MS35265-31	SCREW, MACHINE	EA	4
2	24	PAFFF		12867	0376-741	HEAT SINK ASSY	EA	1
2	25	PAFZZ	5305-00-837-8918	96906	MS35274-64	SCREW, MACHINE	EA	2
2	26	PAFZZ	5310-00-619-1148	96906	MS15795-808	WASHER, FLAT	EA	4
2	27	PAFZZ	5305-00-054-6656	96906	MS35338-138	SCREW, MACHINE	EA	2
2	28	PAFZZ	5310-00-934-9751	96906	MS35650-302	NUT, PLAIN, HEXAGON	EA	2
2	29	XAFFF		96906	MS35274-64	SCREW, MACHINE	EA	2
2	30	PAFZZ	5310-00-619-1148	96906	MS15795-808	WASHER, FLAT	EA	4
2	31	PAFZZ	5305-00-054-6656	96906	MS35338-138	SCREW, MACHINE	EA	2
2	32	PAFZZ	5310-00-934-9751	96906	MS35650-302	NUT, PLAIN, HEXAGON	EA	2
2	33	XAFZZ		30161	0376-440-202	HEAT SINK	EA	1
2	34	PAFZZ	5305-00-497-7401	96906	MS51861-25C	SCREW, TAPPING, THREA	EA	2
2	35	PAFZZ	5961-00-676-9116	81349	1N1204	SEMICONDUCTOR DEVIC	EA	2
2	36	PAFZZ	5305-00-837-8918	96906	MS35274-64	SCREW, MACHINE	EA	1
2	37	PAFZZ	5310-00-619-1148	96906	MS15795-808	WASHER, FLAT	EA	2
2	38	PAFZZ	5305-00-054-6656	96906	MS35338-138	SCREW, MACHINE	EA	1
2	39	PAFZZ	5310-00-934-9751	96906	MS35650-302	NUT, PLAIN, HEXAGON	EA	1

SECTION II (1) ILLUSTRATION		(2)	(3)	TM11-6130-245-24P-2		(6)	(7)	(8)
(A) FIG NO	(B) ITEM NO	SMR CODE	NATIONAL STOCK NUMBER	FSCM	PART NUMBER	DESCRIPTION	USABLE ON CODE U/M	QTY INC IN UNIT
2	40	PAFZZ	5305-00-622-9478	96906	MS35265-49	SCREW, MACHINE	EA	2
2	41	PAFZZ	5310-00-880-5978	96906	MS15795-807	WASHER, FLAT	EA	4
2	42	PAFZZ	5310-00-933-8119	96906	MS35338-137	WASHER, LOCK	EA	2
2	43	PAFZZ	5310-00-934-9759	96906	MS35649-284	NUT, FLAIN, HEXAGON	EA	2
2	44	PAFZZ		12867	0376-1012	INSULATOR, HEATSINK	EA	1
2	45	XDFZZ		12867	T0623	TRANSFORMER, POWER	EA	1
2	46	PAFZZ	5305-00-622-9483	96906	MS35265-81	SCREW, MACHINE	EA	4
2	47	PAFZZ	5310-00-582-5677	96906	MS15795-810	WASHER, FLAT	EA	8
2	48	PAFZZ	5310-00-933-8121	96906	MS35338-139	WASHER, LOCK	EA	4
2	49	PAFZZ	5310-00-250-9477	96906	MS35649-2254	NUT, FLAIN, HEXAGON	EA	4
2	50	MFFZZ		75382	MS600-10	PLATE, MARKING, BLANK	EA	1
2	51	XDFZZ	5940-00-983-6051	81349	37TB10	TERMINAL BOARD	EA	1
2	52	PAFZZ	5305-00-582-5808	96906	MS35265-31	SCREW, MACHINE	EA	4
2	53	PAFZZ	5310-00-722-5998	96906	MS15795-805	WASHER, FLAT	EA	4
2	54	PAFZZ	5310-00-929-6395	96906	MS35338-136	WASHER, LOCK	EA	4
2	55	XDFZZ		91833	743	GROMMET, RUBBER	EA	2
2	56	XDFZZ	5940-00-269-2219	81349	PB01FA04	POST, BINDING, ELECTR	EA	1
2	57	XDFZZ	5940-00-983-6045	81349	37TB4	TERMINAL BOARD	EA	1
2	58	PAFZZ	5305-00-582-5808	96906	MS35265-31	SCREW, MACHINE	EA	4
2	59	PAFZZ	5310-00-722-5998	96906	MS15795-805	WASHER, FLAT	EA	4
2	60	PAFZZ	5310-00-929-6395	96906	MS35338-136	WASHER, LOCK	EA	4
2	61	MFFZZ		75382	MS600-4	PLATE, DESIGNATION	EA	1
2	62	XDFZZ	5940-00-269-2220	58474	DF31RC	POST, BINDING, ELECTR	EA	1
2	63	MFFZZ		12867	0376-1031	COVER, TERM BOARD	EA	1
2	64	XDFZZ		06540	8213A0632	STANDOFF	EA	4
2	65	PAFZZ	5305-00-579-2139	96906	MS35265-30	SCREW, MACHINE	EA	4
2	66	PAFZZ	5310-00-722-5998	96906	MS15795-805	WASHER, FLAT	EA	4
2	67	XDFZZ	5940-00-983-6045	81349	37TB4	TERMINAL BOARD	EA	1
2	68	PAFZZ	5305-00-514-7506	96906	MS35265-26	SCREW, MACHINE	EA	4
2	69	PAFZZ	5310-00-929-6395	96906	MS35338-136	WASHER, LOCK	EA	4
2	70	PAFZZ	5310-00-722-5998	96906	MS15795-805	WASHER, FLAT	EA	8
2	71	PAOZZ		81774	3-16	LINE CORD	EA	1
2	72	MFFZZ		12867	0376-753-1	PANEL, TOP	EA	1
2	73	PAFZZ	5305-00-226-7907	96906	MS35274-45	SCREW, MACHINE	EA	4
2	74	PAFZZ	5310-00-619-1148	96906	MS15795-808	WASHER, FLAT	EA	4
2	75	PAFZZ	5305-00-054-6656	96906	MS35338-138	SCREW, MACHINE	EA	4
2	76	MHFZZ		12867	0376-753-2	PANEL, BACK	EA	1
2	77	PAFZZ	5305-00-226-7907	96906	MS35274-45	SCREW, MACHINE	EA	6
2	78	PAFZZ	5310-00-619-1148	96906	MS15795-808	WASHER, FLAT	EA	6
2	79	PAFZZ	5305-00-054-6656	96906	MS35338-138	SCREW, MACHINE	EA	6

SECTION II		TM11-6130-245-24P-2							
(1)	(2)	(3)	(4)	(5)	(6)	(7)	(8)		
ILLUSTRATION					DESCRIPTION		QTY		
(A)	(B)	NATIONAL		PART			INC		
FIG	ITEM	STOCK	FSCM	NUMBER		USABLE ON CODE	U/M	IN	UNIT
NO	NO	NUMBER							
2	80	MDGZZ		12867	0376-753-3	PANEL, SIDE	EA	2	
2	81	MDFZZ		12867	0376-753-4	PANEL, BOTTOM	EA	1	
2	82	PAFZZ	5305-00-226-7907	96906	MS35274-45	SCREW, MACHINE	EA	4	
2	83	PAFZZ	5310-00-619-1148	96906	MS15795-808	WASHER, FLAT	EA	4	
2	84	PAFZZ	5305-00-054-6656	96906	MS35338-138	SCREW, MACHINE	EA	4	

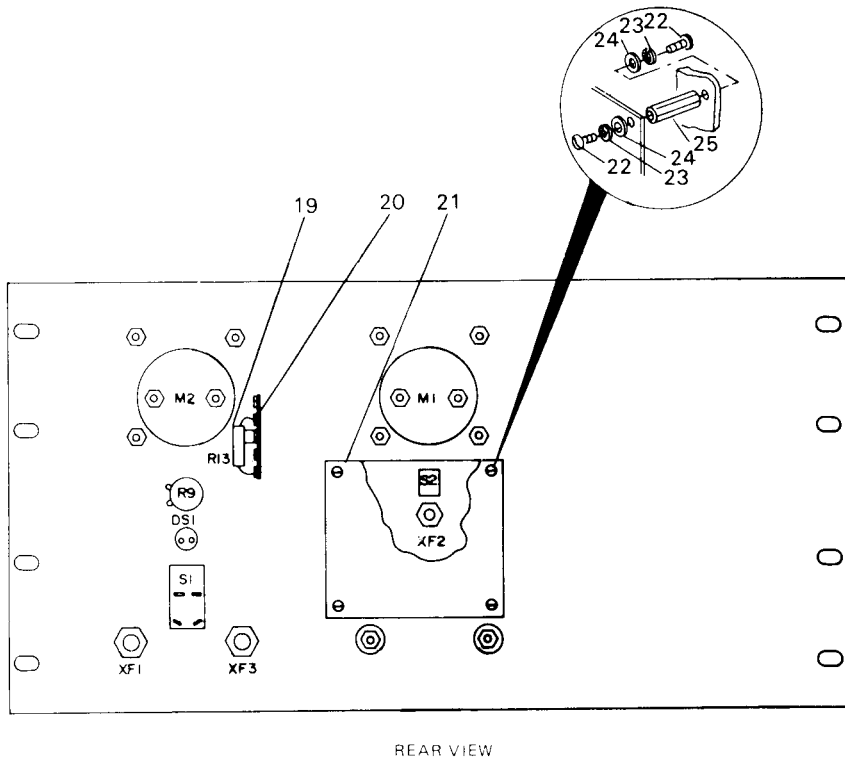
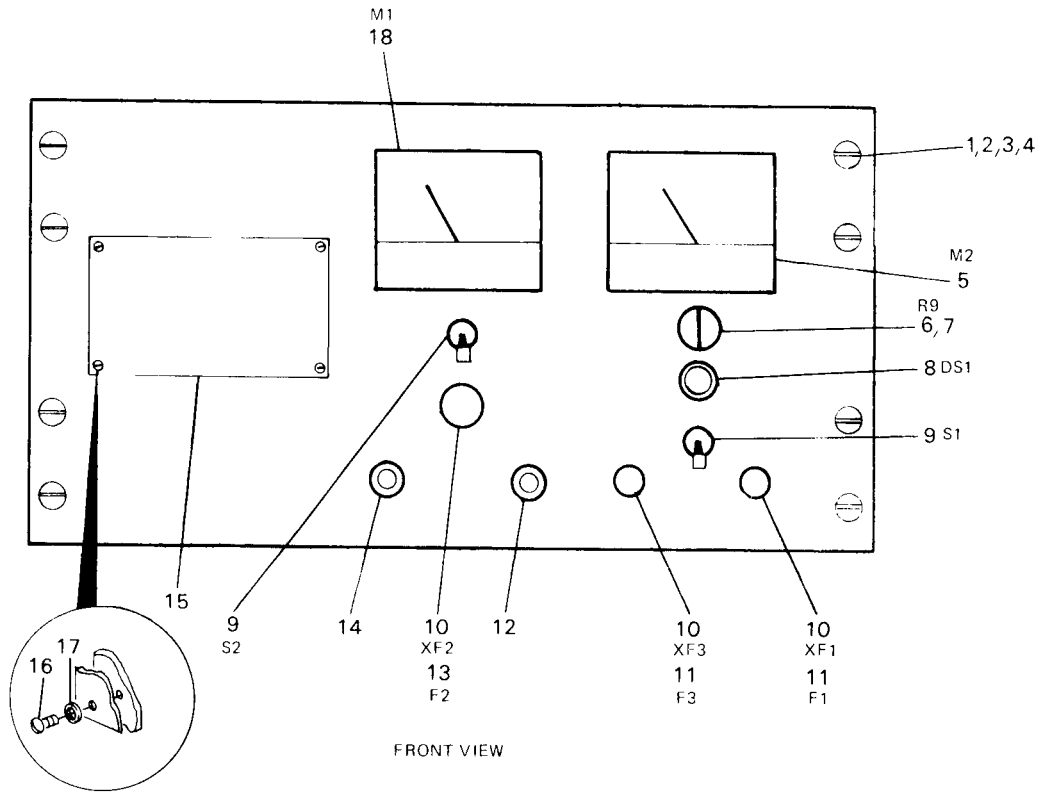
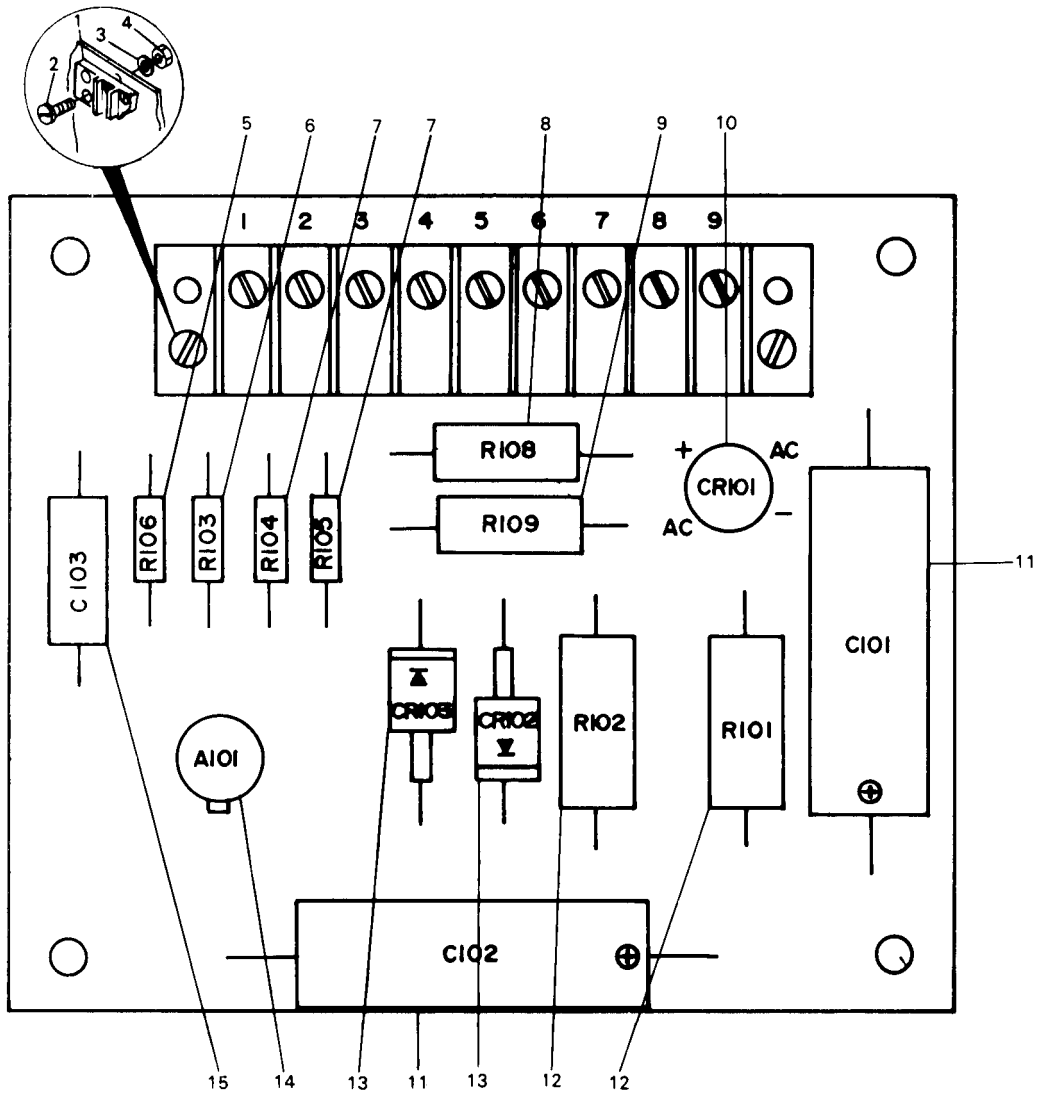

Figure 3. Front Panel Assembly 0376-708

1.1.6G:J005

SECTION II (1) ILLUSTRATION		TM11-6130-245-24P-2		(6)		(7)		(8)	
(A) FIG NO	(B) ITEM NO	(2) SMR CODE	(3) NATIONAL STOCK NUMBER	(4) FSCM	(5) PART NUMBER	DESCRIPTION	USABLE ON CODE	U/M	QTY INC IN UNIT
						GROUP 0101 FRONT PANEL ASSEMBLY			
		XAOFF		12867	0376-708	FRONT PANEL ASSY		EA	1
3	1	PAFZZ	5305-00-226-7907	96906	MS35274-45	SCREW, MACHINE		EA	6
3	2	PAFZZ	5310-00-619-1148	96906	MS15795-808	WASHER, FLAT		EA	6
3	3	PAFZZ	5305-00-054-6656	96906	MS35338-138	SCREW, MACHINE		EA	6
3	4	PAFZZ	5310-00-934-9751	96906	MS35650-302	NUT, FLAIN, HEXAGON		EA	6
3	5	PAFZZ		06046	3-1-2-320S6	VOLTMETER		EA	1
3	6	PAFZZ		12697	3540S1-103	RESISTOR, VARIABLE		EA	1
3	7	PAFZZ	5355-00-543-0789	96906	MS91528-1N2B	KNOB		EA	1
3	8	PAOZZ	6210-00-250-8575	91802	1050C3	LIGHT, INDICATOR		EA	1
3	9	PAFZZ	5930-00-577-0068	27193	7565K5	SWITCH, TOGGLE		EA	2
3	10	PAFZZ	5920-00-892-9311	71400	HKP	FUSEHOLDER, EXTRACTO		EA	3
3	11	PAOZZ	5920-00-296-0679	71400	ABC5	FUSE, CARTRIDGE		EA	2
3	12	PAFZZ	5940-00-269-2220	58474	DF31RC	POST, BINDING, ELECTR		EA	1
3	13	PAFZZ	5920-00-280-9539	71400	ABC20	FUSE, CARTRIDGE		EA	1
3	14	PAFZZ	5940-00-269-2219	81349	PB01FA04	POST, BINDING, ELECTR		EA	1
3	15	MHFZZ		12867	A0376-1070	PLATE, IDENT		EA	1
3	16	PAFZZ	5305-00-531-0298	96906	MS35265-15	SCREW, MACHINE		EA	4
3	17	PAFZZ	5310-00-595-6211	96906	MS15795-803	WASHER, FLAT		EA	4
3	18	PAFZZ		06046	3-1-2-320S38	AMMETER		EA	1
3	19	PAFZZ	5905-00-247-8733	81349	RCR32G562JS	RESISTOR, FIXED, COMP		EA	1
3	20	PAFZZ	5940-00-329-5409	83330	863	TERMINAL BOARD		EA	1
3	21	PAFHH	6130-01-122-3158	12867	0376-707	CIRCUIT CARD ASSEMB		EA	1
3	22	PAFZZ	5305-00-579-2139	96906	MS35265-30	SCREW, MACHINE		EA	8
3	23	PAFZZ	5310-00-929-6395	96906	MS35338-136	WASHER, LOCK		EA	8
3	24	PAFZZ	5310-00-722-5998	96906	MS15795-805	WASHER, FLAT		EA	8
3	25	XDFZZ		06540	8233B0632	STANDOFF		EA	4





EL6GJ006

Figure 4. Printed Circuit Board Assembly 0376-707

SECTION II (1) ILLUSTRATION		TM11-6130-245-24P-2		(6)		(7)		(8)	
(A) FIG NO	(B) ITEM NO	(2) SMR CODE	(3) NATIONAL STOCK NUMBER	(4) FSCM	(5) PART NUMBER	DESCRIPTION	USABLE ON CODE	U/M	QTY INC IN UNIT
GROUP 010101 PRINTED CIRCUIT									
4	1	XDHZZ		75382	410-1921-9PT	TERMINAL BLOCK		EA	1
4	2	PAHZZ	5305-00-622-9472	96906	MS35265-5	SCREW,MACHINE		EA	2
4	3	PAHZZ	5310-00-928-2690	96906	MS35338-134	WASHER,LOCK		EA	2
4	4	PAHZZ	5310-00-934-9738	96906	MS35649-222	NUT,PLAIN,HEXAGON		EA	2
4	5	PAHZZ	5905-00-104-5756	81349	RCR20G105JS	RESISTOR,FIXED,COMP		EA	1
4	6	PAHZZ	5905-00-110-0992	81349	RCR32G511JS	RESISTOR,FIXED,COMP		EA	1
4	7	PAHZZ	5905-00-110-0196	81349	RCR20G102JS	RESISTOR,FIXED,COMP		EA	2
4	8	PAHZZ	5905-00-279-1719	81349	RC32GF103J	RESISTOR,FIXED,COMP		EA	1
4	9	PAHZZ	5905-00-121-9858	81349	RCR32G513JS	RESISTOR,FIXED,COMP		EA	1
4	10	PAHZZ	5961-00-101-2386	83701	PF40	RECTIFIER,SEMICONDU		EA	1
4	11	PAHZZ	5910-01-030-6235	14655	WBR250-25	CAPACITOR,FIXED,ELE		EA	2
4	12	PAHZZ	5905-00-173-1119	81349	RCR42G151JS	RESISTOR,FIXED,COMP		EA	2
4	13	PAHZZ	5961-00-053-1526	04713	1N4740	SEMICONDUCTOR DEVIC		EA	2
4	14	PAHZZ	5962-00-453-7715	07263	741WM	MICROCIRCUIT,LINEAR		EA	1
4	15	PAHZZ	5910-00-649-4490	56289	TVA1207	CAPACITOR,FIXED,ELE		EA	1

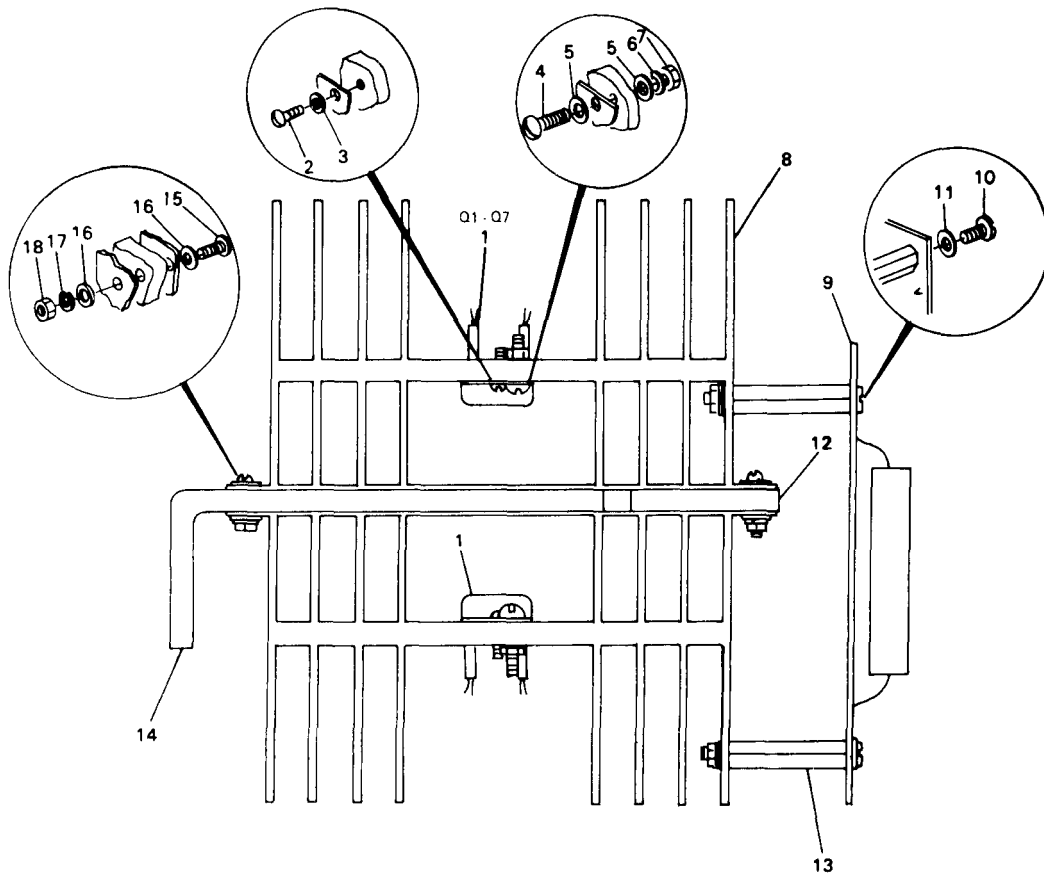

EL6GJ007

Figure 5. Heat Sink Assembly 0376-741

SECTION II (1) ILLUSTRATION		TM11-6130-245-24P-2					(6)	(7)	(8)
(A) FIG NO	(B) ITEM NO	(2) SMR CODE	(3) NATIONAL STOCK NUMBER	(4) FSCM	(5) PART NUMBER	DESCRIPTION	USABLE ON CODE	U/M	QTY INC IN UNIT
						GROUP 0102 HEAT SINK ASSEMBLY			
5	1	PAFZZ	5961-00-929-5014	79089	2N3773	TRANSISTOR		EA	7
5	2	PAFZZ	5305-00-579-2139	96906	MS35265-30	SCREW,MACHINE		EA	14
5	3	PAFZZ	5310-00-722-5998	96906	MS15795-805	WASHER,FLAT		EA	14
5	4	PAFZZ	5305-00-837-8918	96906	MS35274-64	SCREW,MACHINE		EA	2
5	5	PAFZZ	5310-00-619-1148	96906	MS15795-808	WASHER,FLAT		EA	4
5	6	PAFZZ	5305-00-054-6656	96906	MS35338-138	SCREW,MACHINE		EA	2
5	7	PAFZZ	5310-00-934-9751	96906	MS35650-302	NUT,PLAIN,HEXAGON		EA	2
5	8	PAFZZ		30161	6055	HEAT SINK		EA	2
5	9	XAFFF		12867	0376-717	RESISTOR ASSY		EA	1
5	10	PAFZZ	5305-00-582-5808	96906	MS35265-31	SCREW,MACHINE		EA	4
5	11	PAFZZ	5310-00-722-5998	96906	MS15795-805	WASHER,FLAT		EA	4
5	12	PAFZZ		12867	0376-739-1	SPACER,HEAT SINK		EA	1
5	13	PAFZZ		06540	9743A0632	STANDOFF		EA	4
5	14	XAFZZ		12867	0376-739	HEAT SINK BRACKET		EA	1
5	15	PAFZZ	5305-00-582-5808	96906	MS35265-31	SCREW,MACHINE		EA	4
5	16	PAFZZ	5310-00-722-5998	96906	MS15795-805	WASHER,FLAT		EA	8
5	17	PAFZZ	5310-00-929-6395	96906	MS35338-136	WASHER, LOCK		EA	4
5	18	PAFZZ	5310-00-934-9761	96906	MS35649-264	NUT,PLAIN,HEXAGON		EA	4

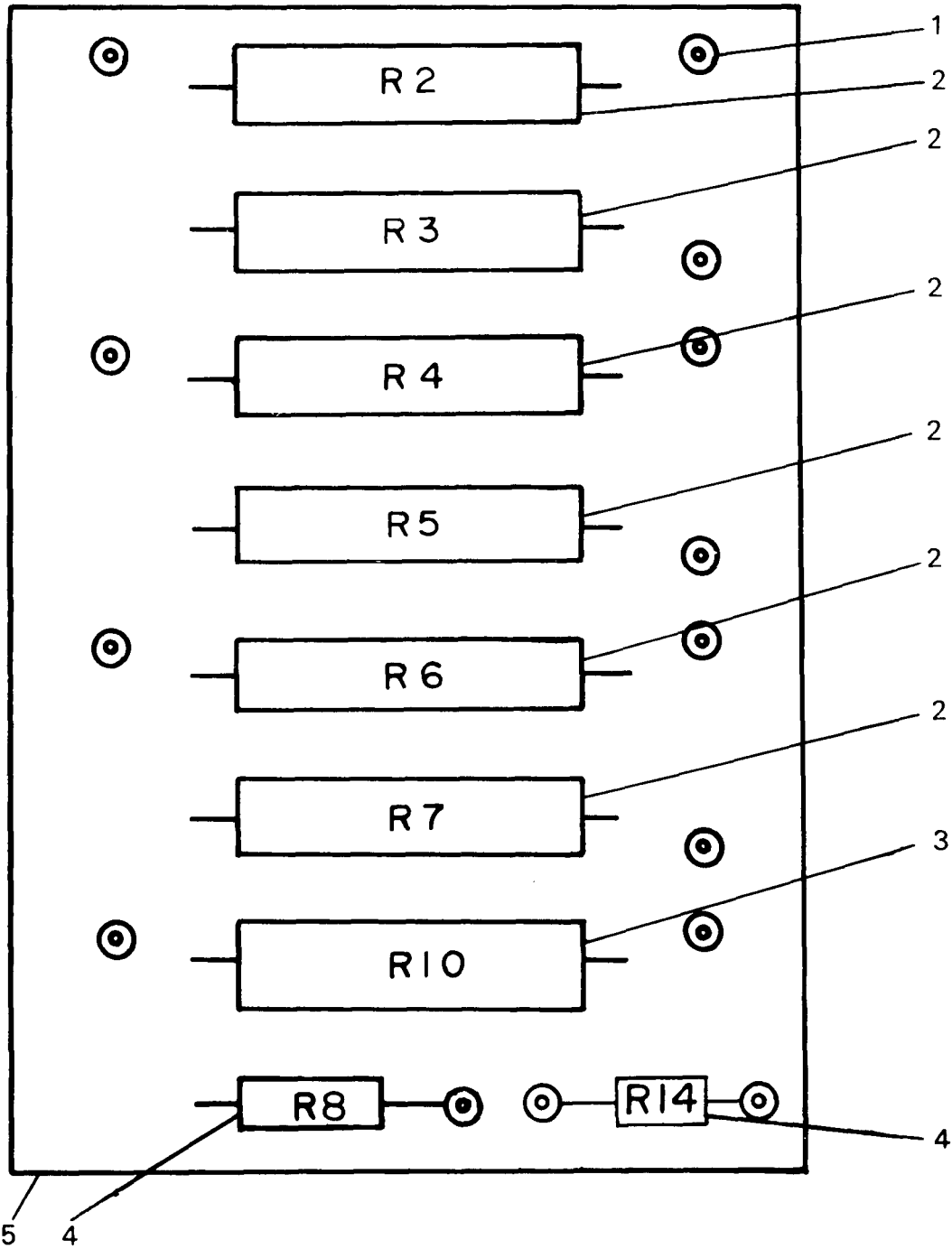

EL6GJ008

Figure 6. Resistor Board Assembly 0376-717

SECTION II		TM11-6130-245-24P-2						
(1)	(2)	(3)	(4)	(5)	(6)	(7)	(8)	
ILLUSTRATION		NATIONAL			DESCRIPTION		QTY	
(A)	(B)	STOCK	FSCM	PART		USABLE ON CODE	INC	
FIG	ITEM	NUMBER		NUMBER			IN	
NO	NO						UNIT	
GROUP 010201 RESISTOR BOARD ASSEMBLY								
6	1	PAFZZ	5940-00-725-9498	81349	SE12XC07		EA 11	
6	2	PAFZZ	5905-01-073-2458	81349	RW68VR56		EA 6	
6	3	PAFZZ	5905-00-975-1153	81349	RW68V511		EA 1	
6	4	PAFZZ	5905-00-279-1922	81349	RC42GF271J		EA 1	
6	5	PAFZZ		12867	0376-383		EA 1	

NOTE: LATEST NATIONAL STOCK NUMBER AND PART NUMBER ASSIGNMENTS ARE INCLUDED AT END OF INDEX.

STOCK NUMBER	FIGURE NO	ITEM NO	STOCK NUMBER	FIGURE NO	ITEM NO
5961-00-053-1520	4	13	5310-00-619-1148	2	83
5305-00-054-6656	2	9	5310-00-619-1148	3	2
5305-00-054-6656	2	27	5310-00-619-1148	5	5
5305-00-054-6656	2	31	5305-00-622-9472	4	2
5305-00-054-6656	2	38	5305-00-622-9478	2	40
5305-00-054-6656	2	75	5305-00-622-9483	2	46
5305-00-054-6656	2	79	5910-00-649-4490	4	15
5305-00-054-6656	2	84	5961-00-676-9116	2	35
5305-00-054-6656	3	3	5310-00-722-5998	2	4
5305-00-054-6656	5	6	5310-00-722-5998	2	12
5961-00-101-2386	4	10	5310-00-722-5998	2	21
5905-00-104-5756	4	5	5310-00-722-5998	2	53
5905-00-110-0196	4	7	5310-00-722-5998	2	59
5905-00-110-0992	4	6	5310-00-722-5998	2	66
5905-00-121-9858	4	9	5310-00-722-5998	2	70
5910-00-151-7564	2	16	5310-00-722-5998	3	24
5905-00-173-1119	4	12	5310-00-722-5998	5	3
5305-00-226-7907	2	73	5310-00-722-5998	5	11
5305-00-226-7907	2	77	5310-00-722-5998	5	16
5305-00-226-7907	2	82	5940-00-725-9498	6	1
5305-00-226-7907	3	1	5305-00-837-8918	2	7
5905-00-247-8733	3	19	5305-00-837-8918	2	25
6210-00-250-8575	3	8	5305-00-837-8918	2	36
5310-00-250-9477	2	49	5305-00-837-8918	5	4
5940-00-269-2219	2	56	5310-00-880-5978	2	41
5940-00-269-2219	3	14	5920-00-892-9311	3	10
5940-00-269-2220	2	62	5310-00-928-2690	4	3
5940-00-269-2220	3	12	5961-00-929-5014	5	1
5905-00-279-1719	4	8	5310-00-929-6395	2	5
5905-00-279-1922	6	4	5310-00-929-6395	2	13
5920-00-280-9539	3	13	5310-00-929-6395	2	22
5920-00-296-0679	3	11	5310-00-929-6395	2	54
5940-00-329-5409	3	20	5310-00-929-6395	2	60
5962-00-453-7715	4	14	5310-00-929-6395	2	69
7021-00-483-0051	2	1	5310-00-929-6395	3	23
5305-00-497-7401	2	34	5310-00-929-6395	5	17
5305-00-514-7506	2	68	5310-00-933-8119	2	42
5305-00-531-0298	3	16	5310-00-933-8121	2	48
5355-00-543-0789	3	7	5310-00-934-9738	4	4
5930-00-577-0068	3	9	5310-00-934-9751	2	10
5305-00-579-2136	2	3	5310-00-934-9751	2	28
5305-00-579-2139	2	11	5310-00-934-9751	2	32
5305-00-579-2139	2	65	5310-00-934-9751	2	39
5305-00-579-2139	3	22	5310-00-934-9751	3	4
5305-00-579-2139	5	2	5310-00-934-9751	5	7
5310-00-582-5677	2	47	5310-00-934-9759	2	43
5305-00-582-5808	2	23	5310-00-934-9761	2	6
5305-00-582-5808	2	52	5310-00-934-9761	2	14
5305-00-582-5808	2	58	5310-00-934-9761	5	18
5305-00-582-5808	5	10	5905-00-975-1153	2	15
5305-00-582-5808	5	15	5905-00-975-1153	6	3
5310-00-595-6211	3	17	5940-00-983-6045	2	57
5310-00-619-1148	2	8	5940-00-983-6045	2	67
5310-00-619-1148	2	26	5940-00-983-6051	2	51
5310-00-619-1148	2	30	5940-00-983-6115	2	19
5310-00-619-1148	2	37	5910-01-030-6235	4	11
5310-00-619-1148	2	74	5905-01-073-2458	6	2
5310-00-619-1148	2	78	6130-01-122-3158	3	21

FSCM	PART NUMBER	FIGURE NO	ITEM NO	FSCM	PART NUMBER	FIGURE NO	ITEM NO
71400	ABC20	3	13	96906	MS15795-805	5	11
71400	ABC5	3	11	96906	MS15795-805	5	16
12867	A0376-1070	3	15	96906	MS15795-807	2	41
37942	CGS143U050D11	2	17	96906	MS15795-808	2	8
58474	DF31RC	2	62	96906	MS15795-808	2	26
58474	DF31RC	3	12	96906	MS15795-808	2	30
71400	HKP	3	10	96906	MS15795-808	2	37
96906	MS15795-803	3	17	96906	MS15795-808	2	74
96906	MS15795-805	2	4	96906	MS15795-808	2	78
96906	MS15795-805	2	12	96906	MS15795-808	2	83
96906	MS15795-805	2	21	96906	MS15795-808	3	2
96906	MS15795-805	2	53	96906	MS15795-808	5	5
96906	MS15795-805	2	59	96906	MS15795-810	2	47
96906	MS15795-805	2	66	96906	MS35265-15	3	16
96906	MS15795-805	2	70	96906	MS35265-26	2	68
96906	MS15795-805	3	24	96906	MS35265-30	2	11
96906	MS15795-805	5	3	96906	MS35265-30	2	65

FSCM	PART NUMBER	FIGURE NO	ITEM NO	FSCM	PART NUMBER	FIGURE NO	ITEM NO
96906	MS35265-30	3	22	81349	PB01FA04	2	56
96906	MS35265-30	5	22	81349	PB01FA04	3	14
96906	MS35265-31	2	23	83701	PF40	4	10
96906	MS35265-31	2	52	81349	RCR20G102JS	4	7
96906	MS35265-31	2	58	81349	RCR20G105JS	4	5
96906	MS35265-31	5	10	81349	RCR32G511JS	4	6
96906	MS35265-31	5	15	81349	RCR32G513JS	4	9
96906	MS35265-32	2	3	81349	RCR32G562JS	3	19
96906	MS35265-49	2	40	81349	RCR42G151JS	4	12
96906	MS35265-5	4	2	81349	RC32GF103J	4	8
96906	MS35265-81	2	46	81349	RC42GF271J	6	4
96906	MS35274-45	2	73	81349	RW68VR56	6	2
96906	MS35274-45	2	77	81349	RW68V511	2	15
96906	MS35274-45	2	82	81349	RW68V511	6	3
96906	MS35274-45	3	1	81349	SE12XC07	6	1
96906	MS35274-64	2	7	56289	TVA1207	4	15
96906	MS35274-64	2	25	12867	T0326	2	18
96906	MS35274-64	2	29	12867	T0623	2	45
96906	MS35274-64	2	36	37942	VR8	2	16
96906	MS35274-64	5	4	14655	WBR250-25	4	11
96906	MS35338-134	4	3	92702	WS2107FL	2	1
96906	MS35338-136	2	5	12867	0376-1012	2	44
96906	MS35338-136	2	13	12867	0376-1029	2	2
96906	MS35338-136	2	22	12867	0376-1031	2	63
96906	MS35338-136	2	54	12867	0376-383	6	5
96906	MS35338-136	2	60	30161	0376-440-202	2	33
96906	MS35338-136	2	69	12867	0376-707	3	21
96906	MS35338-136	3	23	12867	0376-708		
96906	MS35338-136	5	17	12867	0376-717	5	9
96906	MS35338-137	2	42	12867	0376-739	5	14
96906	MS35338-138	2	9	12867	0376-739-1	5	12
96906	MS35338-138	2	27	12867	0376-741	2	24
96906	MS35338-138	2	31	12867	0376-753-1	2	72
96906	MS35338-138	2	38	12867	0376-753-2	2	76
96906	MS35338-138	2	75	12867	0376-753-3	2	80
96906	MS35338-138	2	79	12867	0376-753-4	2	81
96906	MS35338-138	2	84	81349	1N1204	2	35
96906	MS35338-138	3	3	04713	1N4740	4	13
96906	MS35338-138	5	6	91802	1050C3	3	8
96906	MS35338-139	2	48	79089	2N3773	5	1
96906	MS35649-222	4	4	06046	3-1-2-320S38	3	18
96906	MS35649-2254	2	49	06046	3-1-2-320S6	3	5
96906	MS35649-264	2	6	81774	3-16	2	71
96906	MS35649-264	2	14	12697	3540S1-103	3	6
96906	MS35649-264	5	18	81349	37TB10	2	51
96906	MS35649-284	2	43	81349	37TB4	2	57
96906	MS35650-302	2	10	81349	37TB4	2	67
96906	MS35650-302	2	28	81349	38TB2	2	19
96906	MS35650-302	2	32	75382	410-1921-9PT	4	1
96906	MS35650-302	2	39	30161	6055	5	8
96906	MS35650-302	3	4	07263	741HM	4	14
96906	MS35650-302	5	7	91833	743	2	55
96906	MS51861-25C	2	34	27193	7565K5	3	9
75382	MS600-10	2	50	06540	8213A0632	2	64
75382	MS600-4	2	61	06540	8233B0632	3	25
75382	MS601-2	2	20	83330	863	3	20
96906	MS91528-1N2B	3	7	06540	9743A0632	5	13

## LATEST NATIONAL STOCK NUMBER ASSIGNMENTS

STOCK NUMBER	FIGURE NO.	ITEM NO.
6310-00-752-2215	1	1

## LATEST PART NUMBER ASSIGNMENTS

FSCM	PART NUMBER	FIGURE NO.	ITEM NO.
12867	MODEL TR100	1	1



**By Order of the Secretary of the Army**

**Official:**

**ROBERT M. JOYCE**  
*Brigadier General, United States Army*  
*The Adjutant General*

**E. C. MEYER**  
*General, United States Army*  
*Chief of Staff*

RECOMMENDED CHANGES TO EQUIPMENT TECHNICAL PUBLICATIONS

SOMETHING WRONG WITH THIS PUBLICATION?



THEN... JOT DOWN THE DOPE ABOUT IT ON THIS FORM. CAREFULLY TEAR IT OUT. FOLD IT AND DROP IT IN THE MAIL!

FROM: (PRINT YOUR UNIT'S COMPLETE ADDRESS)  
 Commander  
 Stateside Army Depot  
 ATTN: AMSTA-US  
 Stateside, N.J. 07703

DATE SENT  
 10 July 1975

PUBLICATION NUMBER  
 TM 11-5840-340-12

PUBLICATION DATE  
 23 Jan 74

PUBLICATION TITLE  
 Radar Set AN/PRC-76

BE EXACT. PIN-POINT WHERE IT IS

PAGE NO	PARA-GRAPH	FIGURE NO	TABLE NO
---------	------------	-----------	----------

2-25	2-28		
------	------	--	--

3-10	3-3		3-1
------	-----	--	-----

5-6	5-8		
-----	-----	--	--

F03

IN THIS SPACE TELL WHAT IS WRONG AND WHAT SHOULD BE DONE ABOUT IT:

Recommend that the installation antenna alignment procedure be changed throughout to specify a 2° IFF antenna lag rather than 1°.

REASON: Experience has shown that with only a 1° lag, the antenna servo system is too sensitive to wind gusting in excess of 25 knots, and has a tendency to rapidly accelerate and decelerate as it hunts, causing strain to the drive train. Hunting is minimized by adjusting the lag to 2° without degradation of operation.

Item 5, Function column. Change "2 db" to "3db."

REASON: The adjustment procedure the the TRANS POWER FAULT indicator calls for a 3 db (500 watts) adjustment to light the TRANS POWER FAULT indicator.

Add new step f.1 to read, "Replace cover plate removed in step e.1, above."

REASON: To replace the cover plate.

Zone C 3. On J1-2, change "+24 VDC to "+5 VDC."

REASON: This is the output line of the 5 VDC power supply. +24 VDC is the input voltage.

TEAR ALONG PERFORATED LINE

PRINTED NAME, GRADE OR TITLE, AND TELEPHONE NUMBER  
 SSG I. M. DeSpirito 999-1776

SIGN HERE



FILL IN YOUR  
UNIT'S ADDRESS



FOLD BACK

DEPARTMENT OF THE ARMY

\_\_\_\_\_  
\_\_\_\_\_

OFFICIAL BUSINESS  
PENALTY FOR PRIVATE USE \$300

POSTAGE AND FEES PAID  
DEPARTMENT OF THE ARMY  
DOD 314



TEAR ALONG PERFORATED LINE

Commander  
US Army Communications-  
Electronics Command  
ATTN: DRSEL-ME-MQ  
Fort Monmouth, New Jersey 07703

# THE METRIC SYSTEM AND EQUIVALENTS

## WEIGHT MEASURE

1 Centimeter = 10 Millimeters = 0.01 Meters = 0.3937 Inches  
 1 Meter = 100 Centimeters = 1000 Millimeters = 39.37 Inches  
 1 Kilometer = 1000 Meters = 0.621 Miles

## WEIGHTS

1 Gram = 0.001 Kilograms = 1000 Milligrams = 0.035 Ounces  
 1 Kilogram = 1000 Grams = 2.2 lb.  
 1 Metric Ton = 1000 Kilograms = 1 Megagram = 1.1 Short Tons

## LIQUID MEASURE

1 Milliliter = 0.001 Liters = 0.0338 Fluid Ounces  
 1 Liter = 1000 Milliliters = 33.82 Fluid Ounces

## SQUARE MEASURE

1 Sq. Centimeter = 100 Sq. Millimeters = 0.155 Sq. Inches  
 1 Sq. Meter = 10,000 Sq. Centimeters = 10.76 Sq. Feet  
 1 Sq. Kilometer = 1,000,000 Sq. Meters = 0.386 Sq. Miles

## CUBIC MEASURE

1 Cu. Centimeter = 1000 Cu. Millimeters = 0.06 Cu. Inches  
 1 Cu. Meter = 1,000,000 Cu. Centimeters = 35.31 Cu. Feet

## TEMPERATURE

$5/9(^{\circ}\text{F} - 32) = ^{\circ}\text{C}$   
 212° Fahrenheit is equivalent to 100° Celsius  
 90° Fahrenheit is equivalent to 32.2° Celsius  
 32° Fahrenheit is equivalent to 0° Celsius  
 $9/5^{\circ}\text{C} + 32 = ^{\circ}\text{F}$

## APPROXIMATE CONVERSION FACTORS

TO CHANGE	TO	MULTIPLY BY
Inches	Centimeters	2.540
Feet	Meters	0.305
Yards	Meters	0.914
Miles	Kilometers	1.609
Square Inches	Square Centimeters	6.451
Square Feet	Square Meters	0.093
Square Yards	Square Meters	0.836
Square Miles	Square Kilometers	2.590
Acres	Square Hectometers	0.405
Cubic Feet	Cubic Meters	0.028
Cubic Yards	Cubic Meters	0.765
Fluid Ounces	Milliliters	29.573
arts	Liters	0.473
gallons	Liters	0.946
Ounces	Liters	3.785
Pounds	Grams	28.349
Short Tons	Kilograms	0.454
Pound-Feet	Metric Tons	0.907
Pounds per Square Inch	Newton-Meters	1.356
Miles per Gallon	Kilopascals	6.895
Miles per Hour	Kilometers per Liter	0.425
	Kilometers per Hour	1.609

TO CHANGE	TO	MULTIPLY BY
Centimeters	Inches	0.394
Meters	Feet	3.280
Meters	Yards	1.094
Kilometers	Miles	0.621
Square Centimeters	Square Inches	0.155
Square Meters	Square Feet	10.764
Square Meters	Square Yards	1.196
Square Kilometers	Square Miles	0.386
Square Hectometers	Acres	2.471
Cubic Meters	Cubic Feet	35.315
Cubic Meters	Cubic Yards	1.308
Milliliters	Fluid Ounces	0.034
Liters	Pints	2.113
Liters	Quarts	1.057
gallons	Gallons	0.264
ounces	Ounces	0.035
pounds	Pounds	2.205
Metric Tons	Short Tons	1.102
Newton-Meters	Pounds-Feet	0.738
Kilopascals	Pounds per Square Inch	0.145
Kilometers per Liter	Miles per Gallon	2.354
Kilometers per Hour	Miles per Hour	0.621



**PIN: 051201-000**